

Gridding ceiling recessed curved module for continuous light pattern design from the Mosaic TROLL family.

DESCRIPTION

Gridding ceiling recessed curved module for continuous light pattern design from the Mosaic TROLL family. Luminaire set an advanced and innovative thermal balance system through passive dissipation with stable colour temperature of 4000° K (cold white) optimised to be used as general lighting in offices, Schools, commercial centres etc. Luminaires has been designed to be recessed in suspended gridding ceilings. Luminaire housing is made of steel sheet, coated with white (RAL 9016) powder paint resistant to UV. Luminaire build in a PMMA opal diffuser and high efficiency LED light sources with CRI higher than 85 % and a chromatic dispersion lower than 3 SMCD which can work at 8w or 13W depending on the gear we use. Fixture has a luminous flux of 890/1436 Lm, with an efficiency of 80/90 Lm/W and a total consumption of 11/16 W. The average life for the luminaire is 60000 (L80B10) h (established at a minimum flux of 70 % from the original). Luminaire needs a DALI Dimmable control gear fed at 220-240V; 50/60 Hz.(see accessories).

Item code	00SMEPL1811APLXD
Product type	IN
Category	Architectural
Family	Mosaic
Subfamily	Mosaic Led
Materials	Luminaire housing is made of steel sheet, coated with white (RAL 9016) powder paint resistant to UV.
Optical system	Luminaire build in a PMMA opal diffuser and high efficiency LED light sources.
Installation instructions	Luminaires has been designed to be recessed in suspended gridding ceilings. Luminaire needs a DALI Dimmable control gear fed at 220-240V; 50/60 Hz.(see accessories).

Pictograms



Dimensions

Product dimensions (mm) 157 x 564 x 62

Scheme

Scheme

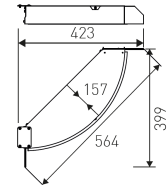

Product

Real power (W)	11/16
Real luminous flux (Lm)	890/1436
Luminous efficiency (Lm/W)	80/90
Beam angle (°)	110
Life time (h)	60000 (L80B10)
IP	20
IK	04
Electrical class insulation	Class 1
Photobiological risk	0 - Exempt
Operating temperature	from 5°C to 30°C
Colour	White
Energy efficiency class	A+
Diffuser	PMMA opal diffuser

Control gear

Control gear DALI Dimmable Electronic Control Gear

Light source

Light source included	Yes
Light source	Led
Nominal power (W)	8/13
Nominal luminous flux (Lm)	1100/18000
Average life time (h)	60000
Colour temperature (K)	4000
Colour consistency (SDCM)	3
CRI	80

Accessories

AG00SLR300-SZ	Stencil to cut ceiling panels for mosaic references AG00SMEPL1811APLX & AG00SMEPL1811APLXD.
AG00SME-ZDA1	Electronic non dimmable gear & connection cable for feeding mosaic luminaires AG00SMEPL2213APLX & AG00SMEPL1811APLX runned at 16W.
AG00SME-ZDB1	Electronic DALI dimmable gear & connection cable for feeding mosaic luminaires AG00SMEPL2213APLX & AG00SMEPL1811APLX runned at 11W.