



Dimensions

Product dimensions (mm)	10 x 2000 x 2,5
Packing dimensions (mm)	150 x 200 x 4
Net weight (g)	90
Gross weight (Kg)	0,14

Scheme

Scheme

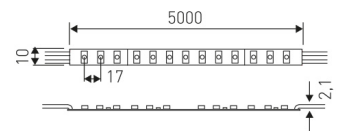

2 m. length high efficiency adhesive flexible LED strip from the TROLL family Flexiled.

DESCRIPTION

2 m. length high efficiency adhesive flexible LED strip from the TROLL family Flexiled setting an advanced and innovative thermal balance system through passive dissipation with stable colour temperature of RGB optimised to be used as indoor or outdoor lighting where environmental integration was a relevant requirement such as bathrooms, kitchen furniture, shelves or retro-illumination. Designed for wall or ceiling surface mounted. Luminaire built in clear silicone UV protected finished in Luminaire built-in a silicone protection diffuser with an angle beam of 120°. Luminaire sets a 13 W LED source with CRI higher than % and a chromatic dispersion lower than 3 SMCD. Fixture has a luminous flux of Lm, with an efficiency of Lm/W and a total consumption of 14,3 W. The average life for the luminaire is 30000 h (stabilised at a minimum flux of 70 % from the original). Luminaire is fed at 220-240V; 50/60 Hz. and needs a constant power auxiliary gear.

Item code	11.7850.1302.02
Product type	IN
Category	Surface Linears
Family	Led Profile
Subfamily	Flexiled
Materials	Luminaire built in clear silicone UV protected.
Optical system	Luminaire built-in a silicone protection diffuser.
Installation instructions	Luminaire designed for wall or ceiling surface mounted.
Pictograms	

Product

Real power (W)	14,3
Beam angle (°)	120
Life time (h)	30000
IP	65
Electrical class insulation	Class 3
Photobiological risk	0 - Exempt
Operating temperature	from -20°C to 35°C
Electrical feeding	24 VDC

Control gear

Control gear	Electronic Control Gear
--------------	-------------------------

Light source

Light source included	Yes
Light source	Led
Nominal power (W)	13
Colour temperature (K)	RGB

Accessories

11.1655.0001.00	WPM control gear receiver from the TROLL family RGB AuxiliarP.
-----------------	----------------------------------------------------------------

Picture



11.1655.0002.00

RGB touch panel from the Analogic Wallpan family of TROLL.

Picture

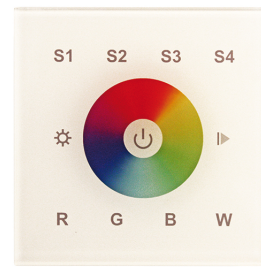

Scheme

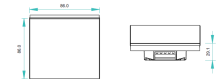

11.1655.0003.00

RGB remote control from the TROLL Family Handpan.

Picture



11.1655.0004.00

WPM booster from the TROLL family RGB AuxiliarP.

Picture



Scheme

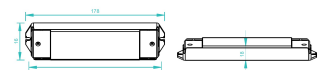

11.7890.0012.20

2 m length recessed profile set. Includes: Anodized aluminium profile (Alu6063-T5) + PC clear diffuser + Installation clips + End caps

Scheme

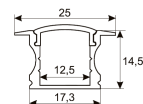

11.7890.0022.20

2 m length surface profile set. Includes:
Anodized aluminium profile (Alu6063-T5)
+ PC clear diffuser + Installation clips +
End caps.

Scheme

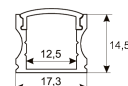

11.7890.0032.20

2 m length 45° surface profile set.
Includes: Anodized aluminium profile
(Alu6063-T5) + PC clear diffuser +
Installation clips + End caps.

Scheme

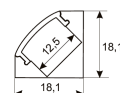

11.7890.1012.20

2 m length recessed profile set. Includes:
Anodized aluminium profile (Alu6063-T5)
+ PC opal diffuser + Installation clips +
End caps

Scheme

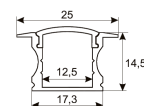

11.7890.1022.20

2 m length surface profile set. Includes:
Anodized aluminium profile (Alu6063-T5)
+ PC opal diffuser + Installation clips +
End caps.

Scheme

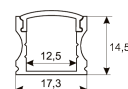

11.7890.1032.20

2 m length 45° surface profile set.
Includes: Anodized aluminium profile
(Alu6063-T5) + PC opal diffuser +
Installation clips + End caps.

Scheme

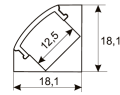

478/33

Upper fastening staples. (1 unit)

Scheme

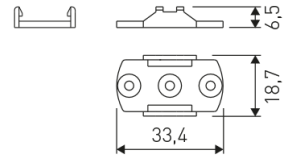

478/C200/00

Transparent cover.

Scheme



478/P200/21

Aluminium profile.

Scheme



478/T/21

Profile covers. (2 units)

Scheme

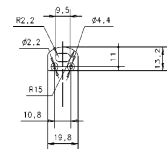

48/04

With terminals up to 4 mm² section. To join 5 mm² silicone cable to 13 mm².

Picture



71/LD10024

96W Power supply driver from the Troll family Standard DriverP.

Picture



Scheme

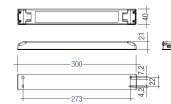

71/LD18024

180W Power supply driver from the Troll family Standard DriverP

Picture



Scheme

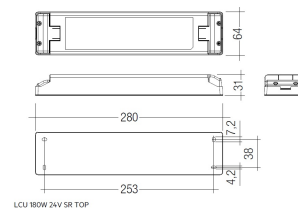

71/LD3524

35W Power supply driver from the Troll family Standard DriverP.

Picture



Scheme

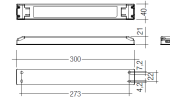

71/LD6024

60W Power supply driver from the Troll family Standard DriverP.

Picture



Scheme

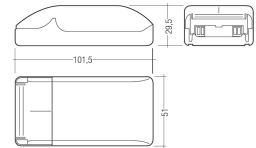

71/LDRD2412504

Dali controller allows control of linear LED luminaires supplied 24V DC.

Picture



Scheme

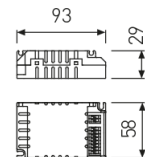

71/LDT06024

60W Power supply driver IP67 from the Troll family Standard DriverP.

Picture



Scheme

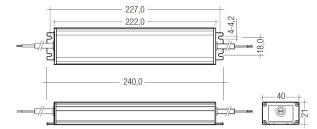

71/LDT9624

96W Power supply driver IP67 from the Troll family Standard DriverP.

Picture



Scheme

