



5 m. length high efficiency adhesive flexible LED strip IP66 from the TROLL family Flexiled.

DESCRIPTION

5 m. length high efficiency adhesive flexible LED strip IP66 from the TROLL family Flexiled setting an advanced and innovative thermal balance system through passive dissipation with stable colour temperature of 2700° K (extra-warm white) optimised to be used as indoor or outdoor lighting where environmental integration was a relevant requirement such as bathrooms, kitchen furniture, shelves or retro-illumination. Designed for wall or ceiling surface mounted. Luminaire built-in an silicone protection diffuser with an angle beam of 120°. Luminaire sets a 5 W/m LED source with CRI higher than 80 % and a chromatic dispersion lower than 3 SMCD. Fixture has a luminous flux of 500 Lm/m, with an efficiency of 100 Lm/W and a total consumption of 5 W/m. The average life for the luminaire is 30000 h (stabilised at a minimum flux of 70 % from the original). Luminaire is fed at 24V, and needs a constant power auxiliary gear.

Item code	11.7851.0582.00
Product type	IN
Category	Linealed
Family	Flexiled
Subfamily	Tajo
Materials	Luminaire built in clear silicone UV protected.
Optical system	Luminaire built-in a silicone protection diffuser.
Installation instructions	Luminaire designed for wall or ceiling surface mounted.
Pictograms	

Dimensions	
Product dimensions (mm)	10 x 5000 x 5
Packing dimensions (mm)	210 x 240 x 4
Net weight (g)	220
Gross weight (Kg)	0,27

Product	
Real power (W)	5
Real luminous flux (Lm)	500
Luminous efficiency (Lm/W)	100
Beam angle (°)	120
Life time (h)	30000
IP	66
Electrical class insulation	Class 3
Photobiological risk	0 - Exempt
Operating temperature	from -20°C to 35°C
Electrical feeding	24 VDC
Energy efficiency class	A+

Control gear	
Control gear	Electronic Control Gear

Light source	
Light source included	Yes
Light source	Led
Nominal power (W)	5
Nominal luminous flux (Lm)	500
Colour temperature (K)	2700
Colour consistency (SDCM)	3
CRI	80

Photometry	
Photometry	

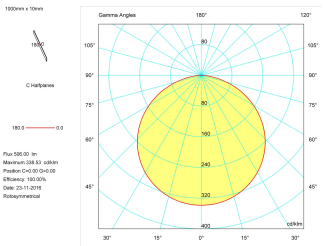

Accesories	
11.1801.7010.00	30W Power supply driver from the Troll family Standard DriverP.
Picture	



Scheme



11.1801.7011.00 60W Power supply driver from the Troll family Standard DriverP.

Picture



Scheme



11.1801.7012.00 120W Power supply driver from the Troll family Standard DriverP.

Picture



Scheme



11.1801.7013.00 180W Power supply driver from the Troll family Standard DriverP.

Picture



Scheme

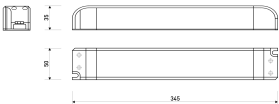

11.1801.7030.00 35W DALI dimmable power supply driver from the Troll family DALI DriverP.

Picture



Scheme



11.1801.7031.00

60W DALI dimmable power supply driver from the Troll family DALI DriverP.

Picture



Scheme



11.1801.7032.00

100W DALI dimmable power supply driver from the Troll family DALI DriverP.

Picture



Scheme



11.1801.7033.00

150W DALI dimmable power supply driver from the Troll family DALI DriverP.

Picture



Scheme

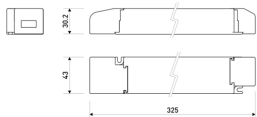

11.7851.0008.00	Quick connector IP66 PCB-cable for flexiled Tajo with PCB width of 8mm. (power of 5W/m & 10W/m)
11.7851.0009.00	Quick connector IP66 PCB-PCB for flexiled Tajo with PCB width of 8mm. (power of 5W/m & 10W/m)
11.7851.0010.00	Installation kit for IP66 Flexiled Tajo with PCB withd of 10 mm, (15W/m and 20W/m). It includes: End cap 5 units. End cap with drill, 5 units. Clip, 10 units. Screw, 10 units. Silicone tube.
11.7890.0011.20	1 m length recessed profile set. Includes: Recessed anodized aluminium profile (Alu6063-T5) + PC clear diffuser + Installation clips + End caps.

Scheme

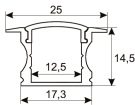

11.7890.0012.20	2 m length recessed profile set. Includes: Anodized aluminium profile (Alu6063-T5) + PC clear diffuser + Installation clips + End caps
-----------------	--

Scheme

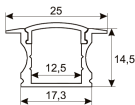

11.7890.0021.20	1 m length surface profile set. Includes: Anodized aluminium profile (Alu6063-T5) + PC clear diffuser + Installation clips + End caps.
-----------------	--

Scheme

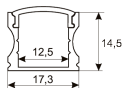

11.7890.0022.20	2 m length surface profile set. Includes: Anodized aluminium profile (Alu6063-T5) + PC clear diffuser + Installation clips + End caps.
-----------------	--

Scheme

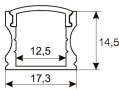

11.7890.0031.20	1 m length 45° surface profile set. Includes: Anodized aluminium profile (Alu6063-T5) + PC clear diffuser + Installation clips + End caps.
-----------------	---

Scheme

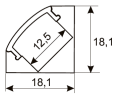

11.7890.0032.20	2 m length 45° surface profile set. Includes: Anodized aluminium profile (Alu6063-T5) + PC clear diffuser + Installation clips + End caps.
-----------------	---

Scheme

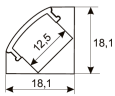

11.7890.0041.04	1 m length wall mounted profile set. Includes: aluminium profile (Alu6063-T5) + PC clear diffuser + Installation clips + End caps.
-----------------	---

Scheme

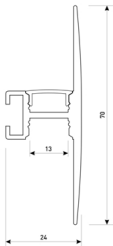

11.7890.0041.20	1 m length wall mounted profile set. Includes: aluminium profile (Alu6063-T5) + PC clear diffuser + Installation clips + End caps.
-----------------	---

Scheme

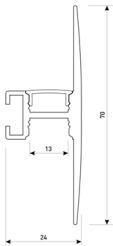

**1 m length wall mounted profile set.**  
**Includes: aluminium profile (Alu6063-T5)+ PC clear diffuser + Installation clips +End caps.**

Scheme

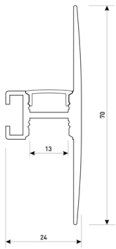

**2 m length wall mounted profile set.**  
**Includes: aluminium profile (Alu6063-T5) + PC clear diffuser + Installation clips + End caps.**

Scheme

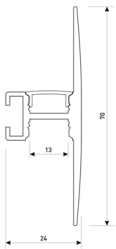

**2 m length wall mounted profile set.**  
**Includes: aluminium profile (Alu6063-T5) + PC clear diffuser + Installation clips + End caps.**

Scheme

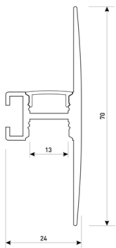

**2 m length wall mounted profile set.**  
**Includes: aluminium profile (Alu6063-T5) + PC clear diffuser + Installation clips + End caps.**

Scheme

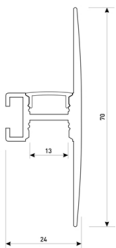

**1 m length of wall recessed profile set.**  
**Includes: Recessed anodized aluminium profile (Alu6063-T5) + PC clear diffuser + Installation clips + End caps.**

Scheme



11.7890.0052.20	2 m length of wall recessed profile set. Includes: Recessed anodized aluminium profile (Alu6063-T5) + PC clear diffuser + Installation clips + End caps.
-----------------	---

Scheme



11.7890.0401.20	Aluminium profile Iraty. Lenght 2m
-----------------	------------------------------------

Scheme

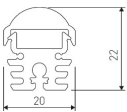

11.7890.0402.00	30° frosted diffuser for profiles Irati & Luna. Length 2 m.
11.7890.0403.00	60° frosted diffuser for profiles Irati & Luna. Length 2 m.
11.7890.0404.00	90° frosted diffuser for profiles Irati & Luna. Length 2 m.
11.7890.0405.00	Opal diffuser for profiles Irati & Luna. Length 2 m.
11.7890.0406.00	Transparent diffuser for profiles Irati & Luna. Length 2 m.
11.7890.0407.00	Frosted diffuser for profiles Irati & Luna. Length 2 m.
11.7890.0409.20	set of end caps for aluminium profile Irati. (2 units by ref.)
11.7890.0410.00	Set of installationclamps for profiles Irati & Luna. (2 units/ref.)

Scheme

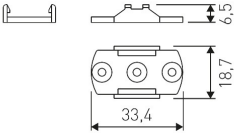

11.7890.0411.00	Joint-ball accessory for aluminium profiles Roncal, Itaty & Luna. (1 unit by reference)
-----------------	---

Scheme

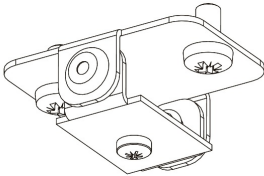

11.7890.0412.03	Accessory for suspension of profiles Roncal, Irati & Luna. (1 unit by reference)
11.7890.0412.33	Accessory for suspension of profiles Roncal, Irati & Luna. (1 unit by reference)
11.7890.0501.20	Aluminium profile Luna. Lenght 2m

Scheme

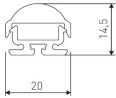

11.7890.0502.20	Set of En caps for aluminium profile Luna. (2 units/ref.).
11.7890.1011.20	1 m length recessed profile set. Includes: Recessed anodized aluminium profile (Alu6063-T5) + PC opal diffuser + Installation clips + End caps.

Scheme

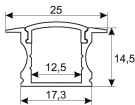

11.7890.1012.20	2 m length recessed profile set. Includes: Anodized aluminium profile (Alu6063-T5) + PC opal diffuser + Installation clips + End caps
-----------------	---

Scheme

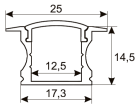

11.7890.1021.20	1 m length surface profile set. Includes: Anodized aluminium profile (Alu6063-T5) + PC opal diffuser + Installation clips + End caps.
-----------------	---

Scheme

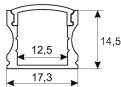

11.7890.1022.20	2 m length surface profile set. Includes: Anodized aluminium profile (Alu6063-T5) + PC opal diffuser + Installation clips + End caps.
-----------------	---

Scheme

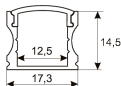

11.7890.1031.20	1 m length 45° surface profile set. Includes: Anodized aluminium profile (Alu6063-T5) + PC opal diffuser + Installation clips + End caps.
-----------------	---



Scheme

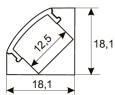

11.7890.1032.20	2 m length 45° surface profile set. Includes: Anodized aluminium profile (Alu6063-T5) + PC opal diffuser + Installation clips + End caps.
-----------------	--

Scheme

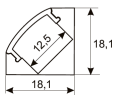

11.7890.1041.04	1 m length wall mounted profile set. Includes: aluminium profile (Alu6063-T5) + PC matt diffuser + Installation clips + End caps.
-----------------	--

Scheme

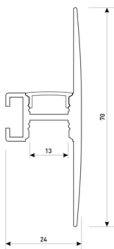

11.7890.1041.20	1 m length wall mounted profile set. Includes: aluminium profile (Alu6063-T5) + PC matt diffuser + Installation clips + End caps.
-----------------	--

Scheme

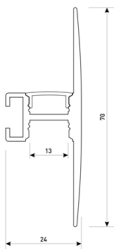

11.7890.1041.33	1 m length wall mounted profile set. Includes: aluminium profile (Alu6063-T5) + PC matt diffuser + Installation clips + End caps.
-----------------	--

Scheme



11.7890.1042.04	2 m length wall mounted profile set. Includes: aluminium profile (Alu6063-T5) + PC matt diffuser + Installation clips + End caps.
-----------------	--

Scheme

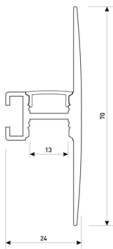

11.7890.1042.20	2 m length wall mounted profile set. Includes: aluminium profile (Alu6063-T5) + PC matt diffuser + Installation clips + End caps.
-----------------	--

Scheme

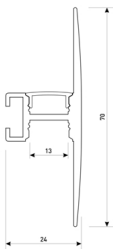

11.7890.1042.33	2 m length wall mounted profile set. Includes: aluminium profile (Alu6063-T5) + PC matt diffuser + Installation clips + End caps.
-----------------	--

Scheme

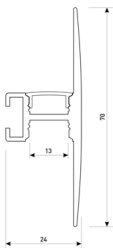

11.7890.1051.20	1 m length of wall recessed profile set. Includes: Recessed anodized aluminium profile (Alu6063-T5) + PC matt diffuser + Installation clips + End caps.
-----------------	--

Scheme



11.7890.1052.20	2 m length of wall recessed profile set. Includes: Recessed anodized aluminium profile (Alu6063-T5) + PC matt diffuser + Installation clips + End caps.
-----------------	--

Scheme



48/04	With terminals up to 4 mm² section. To join 5 mm² silicone cable to 13 mm².
-------	---

Picture



73/DLP	Light dimming controler 12-24V. On/Off Push, Dali, 0-10V, 1-10V. (Master)
--------	---

Picture



73/DLS	Light dimming controler 12-24V. On/Off Push, Dali, 0-10V, 1-10V. (Slave)
--------	--

Picture

